

PROBLEM: Soil is too close to the wall and can cause decay.

SOLUTION #1 Capped foundation.

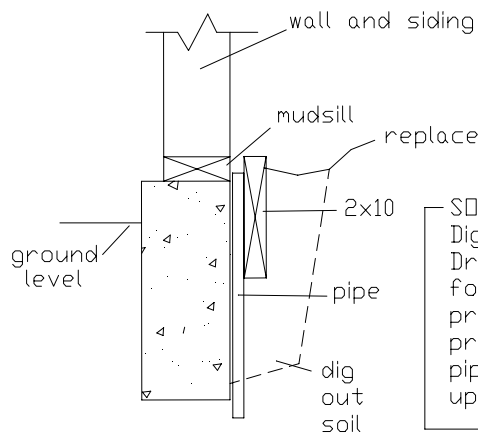
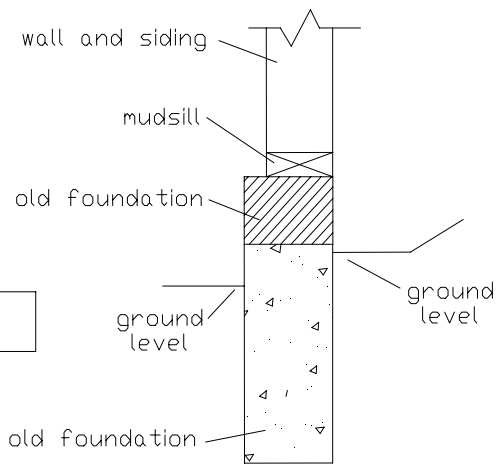

SOLUTION #2 Dig out soil along foundation. Drive plastic pipes down next to foundation about 6 feet apart to provide an air space. Place 2"x10" pressure treated lumber next to pipes to keep soil away. Replace soil up against lumber.